



Shaftesbury Town Council

Town Hall, Shaftesbury, Dorset. SP7 8LY

Telephone: 01747 852420

Town Clerk: Mrs Claire Commons

e-mail:enquiries@shaftesbury-tc.gov.uk

Website:www.shaftesbury-tc.gov.uk

VAT Reg No 241 1307 58

To: Members of Shaftesbury Town Council's Recreation, Open Spaces and Environment Committee (ROSE), Councillors Cook, Hall, Jackson, Kirton, Loader, Proctor. All other recipients for information only.

You are required to attend a meeting of the Recreation, Open Spaces and Environment Committee for the transaction of the business shown on the agenda below.

To be held at 7.00pm on Tuesday 20 March 2018 in the Council Chamber, Shaftesbury Town Hall

Claire Commons, Town Clerk

Members are reminded of their duty under the Code of Conduct

Public Participation

The Chairman will invite members of the public to present their questions, statements or petitions submitted under the Council's Public Participation Procedure.

Members of the public and Councillors are entitled to make audio or visual recordings of the meeting provided it does not cause disruption or impede the transaction of business. Out of courtesy to those present, the Council requests that intention to record proceedings is brought to the Chairman's attention prior to the start of the meeting.

Agenda

- | | | |
|----------|--|-----------|
| 1 | APOLOGIES | 3 |
| | To receive and consider for acceptance, apologies for absence | |
| 2 | DECLARATIONS OF INTEREST | 3 |
| | Members and Officers are reminded of their obligations to declare interests in accordance with the Code of Conduct 2012. The Clerk will report any dispensation requests received. | |
| 3 | MINUTES | 3 |
| | To confirm as a correct record, the minutes of the previous meeting of the Recreation, Open Spaces and Environment Committee. | |
| 4 | SCHEDULED ANCIENT MONUMENTS | 4 |
| | To consider proposal to the Heritage Lottery Fund for the care and future promotion of Shaftesbury's Scheduled Ancient Monuments. | |
| 5 | GOLD HILL WALL | 13 |
| | To consider management plan for vegetation on and on top of the wall | |
| 6 | SALISBURY STREET GREEN | 15 |
| | To consider requesting taking ownership of Salisbury Street Green | |
| 7 | FOOTPATHS | 17 |

To review the condition and access of footpaths in Shaftesbury and identify any actions arising

8	CASTLE MOUND	19
	To consider management and improvement to Castle Mound	
9	WINCOMBE RECREATION GROUND	21
	To agree expenditure for replenishing safety bark at Wincombe Recreation Ground	
10	OFFICER REPORT	22
	To receive and note officer report and any correspondence relating to the work of the Committee	

(End)

**Administration for a meeting of the Recreation, Open Spaces and
Environment Committee**

**To be held at 7.00pm on Tuesday 20 March 2018 in the Council Chamber, Shaftesbury
Town Hall**

1 Apologies

To receive and consider for acceptance, apologies for absence

1.1 Apologies received to date

1.1.1 Councillor Proctor due to personal commitments.

2 Declarations of Interest

Members and Officers are reminded of their obligations to declare interests in accordance with the Code of Conduct 2012. The Clerk will report any dispensation requests received.

2.1 Declarations of Interest received to date

2.1.1 There have been no declarations received at the point of papers being issued.

3 Minutes

To confirm as a correct record, the minutes of the previous meeting of the Recreation, Open Spaces and Environment Committee.

3.1 Minutes to be adopted

3.1.1 13th February 2018

**Report 0318ROSE4 to a meeting of the Recreation, Open Spaces and Environment
Committee**
**To be held at 7.00pm on Tuesday 20 March 2018 in the Council Chamber, Shaftesbury
Town Hall**

4 Scheduled Ancient Monuments

To consider proposal to the Heritage Lottery Fund for the care and future promotion of Shaftesbury's Scheduled Ancient Monuments.

4.1 Recommendation

- 4.1.1 That the Committee considers the "story" document and informs the Shaftesbury Open Spaces Group of any changes needed (see Appendix A below)
- 4.1.2 That the Committee considers a draft Form for Heritage Lottery Fund and informs Shaftesbury Open Spaces Group of any changes needed; (see Appendix B below)
- 4.1.3 That the Committee determines that Shaftesbury Town Council be the formal body to submit the agreed form to HLF with support from the Shaftesbury Open Spaces Group.

4.2 Background

- 4.2.1 Shaftesbury has 6 Scheduled Monuments: Shaftesbury Town Council owns all or part of 3, manages or helps to manage 2 more, and is a statutory planning consultee re the 6th (in private ownership).
- 4.2.2 Greater detail of the project is provided by the Shaftesbury Open Spaces Group at Appendix C below.
- 4.2.3 Historic England has expressed the view that the whole is greater than the sum of its parts, and so deserves more strategically-planned care. In particular:
 - 4.2.3.1 Historic England will not yet take Castle Hill Mound off their national "At Risk" list, & are pressing for jointly-agreed Plans for sites in Shaftesbury Town Council's care;
 - 4.2.3.2 Historic England have strongly advised an Historic Lottery Fund bid for the monuments as a group, to enable Shaftesbury Town Council to implement such Plans.
- 4.2.4 Heritage Lottery Fund South-West chairman met Shaftesbury Town Councillor informally; on his advice, Shaftesbury Open Spaces Group members
 - 4.2.4.1 Prepared a "story" document and then
 - 4.2.4.2 Began to assemble costings in order to complete Heritage Lottery Fund's "Project Enquiry Form", which is the stage before a formal Application and does not need much detail. The Form has to be done online; the applicant has to "register" with Heritage Lottery Fund in order to submit the Form.
- 4.2.5 A diagram of the monuments and their locations is shown at Appendix C below.

4.3 Legal Implications

4.3.1 The Council has a duty to manage its open spaces and protect its Scheduled Ancient Monuments.

4.4 **Financial Implications**

4.4.1 There are no financial implications arising from this report

4.5 **Risk**

4.5.1 There is a risk of the Scheduled Ancient Monuments becoming further at risk if the Council does not take care of them. The approach outlined in the report provides a joined-up approach recommended by subject matter experts.

(End)

Report Author:
Claire Commons, Town Clerk

**Celebrating the long view:
looking out for Shaftesbury's hilltop and scheduled monuments**

Shaftesbury, the highest town in southern England, is widely visible across three counties: Dorset, Wiltshire and Somerset. Once home to England's largest nunnery, and burial-place of this country's only martyred Saxon King, it hosts a series of monuments not just unrivalled in the county, but potentially bearing comparison with the best-known historic cities of the south-west.

The town has dominated its ancient hill-top for longer than a millennium; now it is rapidly expanding, doubling in population within a decade. At this time of great change, the Shaftesbury Open Spaces Group (OSG), along with partners in the new *Celebrating the long view* project are keen to engage all residents, new and old, inspiring everyone to feel passionately about - and take action to preserve and improve - the rich heritage of this historic settlement, to help ensure it has a vibrant future.

The impetus for our project comes from wanting to improve care, knowledge, understanding and use of a unique group of six nationally-recognised historic monuments, remarkably diverse, dating from Saxon to Tudor times:

[i]	Castle Hill: Boltbury	1002724 }
[ii]	Castle Green: late Saxon urban area	1002376 } <i>Historic</i>
[iii]	Abbey ruins including Park Walk	1002672 } <i>England</i>
[iv]	Abbey precinct wall: Gold Hill	1004559 } <i>reference</i>
[v]	Abbey fish ponds	1002377 } <i>numbers</i>
[vi]	St John's churchyard: Bury Litton	1005580 }

Forming a significant part of the town's network of open spaces, vital for wellbeing, these sites give a focus to the story we want to tell – rooted in what we know about the identity of our town, and what we believe about its future for all of our community.

What we know: the identity of Shaftesbury

The land's exceptional underlying shape gave this town its unique site and structure:

“a prominent position on the summit of a projecting Greensand spur,
with precipitous slopes 100ft high on all but the North-East side” [RCHM].

This slender finger of stone, with a spring-line at the foot of its steep cliffs, both attracted safe settlement and dictated its compressed form - elevated, on an edge:

- higher than 210 metres across most of its central area, it can fairly lay claim to being the highest town in southern England;
- it straddles an edge between the higher chalk plateau of Cranborne Chase and the West Wiltshire Downs (an AONB) to its east and north, and the lush pastures of low-lying Blackmore Vale to its south and west.

The position of Shaftesbury enabled the earliest settlement:

- we have evidence that this place and its surroundings were used and occupied for much of pre-history. The earliest artefact found here to date is a hand-axe 200,000 years old, from Castle Hill. The town sits in roughly the centre of a great arc of Iron-Age hillfort sites, from White Sheet Castle in the north, to Winklebury in the east, Hambledon in the south, and Cadbury Castle to the west;
- it offered “prospect and refuge”: it has an outlook, and can be defended. King Alfred chose it as one of four “burgh” defence sites in Dorset against the Vikings;
- it dominates its surroundings: an ideal site for Alfred's Royal nunnery, twin of his Royal monastery at Athelney in Somerset;

- deep hollow-ways (made by feet, hooves, wheels and water) suggest it drew travelers in numbers very early. Communications persisted - long distance routes, and local networks: generating what became an old south-north route from coastal ports to the midlands (for part of its length, the Roman Fosse Way), and attracting the east-west turnpike and post-route from London to Exeter.

Hence it became a focal point for commerce, communications and travelers.

The same position also dictated the structure of Shaftesbury:

- owing to steep flanks on three sides, it had to develop first along the spur, then as a compact kernel clustering round the brow of its slopes. Its physical shape had other practical consequences: people, horses and livestock, approaching uphill from three directions, stopped here for rest and refreshment. This staging-post role, and the town's market, led to many coaching inns and carriers' pubs;
- its early assets – its physical position, burgh, Royal nunnery, and crossing-point of long-distance routes - attracted further activity. It became a Royal centre: under later Saxon kings it housed three Royal mints, more than any other Dorset town. The abbey, having as its first abbess Arthur's daughter Princess Ethelgifu, was the burial place of a Queen (Aelfgifu) and of her grandson, the martyred King Edward. Here King Cnut died, Robert the Bruce's Queen was held hostage, and Catherine of Aragon (future Queen of Henry VIII) stayed on her way to the English court. At its peak, the Abbey had a European significance of scale.

Shaftesbury is a classic example of a hill-top town: a specific type of settlement. Only a handful of hill-towns occur in southern England (Painswick, Stow, Chipping Norton, Bradford on Avon); Shaftesbury is even rarer in being so focused on the hill's top rather than its slopes - more characteristic of rural landscapes elsewhere such as Italy. Its unique combination of distinguishing characteristics includes:

- **intensity of form:** an old town centre that is compact, self-contained and enclosed, like a labyrinth;
- **skyline:** a distinctive silhouette of buildings among trees;
- **a signature local building-material:** green sandstone, quarried from beneath our feet, marks out many older buildings public or private, and the walls of gardens and lanes;
- **glimpses out:** not only from open-space viewpoints but also between buildings, through archways, or down ancient hollow lanes, side-roads and paths descending the slopes;
- **town and country juxtaposed and inter-connected:** a typical landscape feature locally is wooded ridges separating higher downs or scarps from lower land (with embayments between, land carved by water in past eras), such as Kingsettle Wood north of the town or The Wilderness (old quarries) to the south: fingers of country coming in, while fingers of town reach out along main roads;
- **town and sub-urb:** the relation between a compact centre at the summit, and outlying areas downhill - St James to the south, Enmore Green to the north - more akin to southern French towns;
- **cultural historic assets:** at the town's heart is the assemblage of monuments, five within a short level walk of each other - the Abbey ruins, Gold Hill wall, Castle Hill's Green and Mound, and the Bury Litton. This grouping is unrivalled in the county, and has even wider potential;
- **centre for cultural and healthy pursuits:** with music groups, choirs, musical and theatrical performances, art and photography groups and exhibitions, festivals and carnivals year-round in the Arts Centre, Town Hall, churches and church halls; thriving groups practising yoga, pilates, Nordic walking and tai-chi, bowls, football, tennis and swimming facilities, and a stopping-point for touring cyclists and walkers on long-distance routes such as the new White Hart Link.

What we believe: where we stand now, and its meaning for our future

Because of the unique combination of factors outlined above, Shaftesbury is a classic case of a whole greater than the sum of its parts, with much untapped potential. Equally, if nothing is done, we run the risk of squandering our rare assets, as we stand at a point of considerable change in the town. Local Authorities are withdrawing services and money, while town planning is under pressure; all these factors tend to squeeze out creative thinking and action. That is why we want to draw in all of our community, from the long-standing to the newest arrivals. Each of us can be an equal part of this story, all involved in helping to write its next chapter.

The scale of the group of nationally-recognised monuments at the town's heart is unequalled in Dorset. With these as the springboard for a new initiative, we can realistically aim to put our hill-top town on a par with larger urban centres in the South-West. To achieve a cumulative impact - rivaling historic cities such as Winchester, Exeter or Salisbury – we need to:

- **explore** our town's ancient origins, especially its pre-history: from our oldest residents to our newest arrivals, everyone can share the excitement of discovering our furthest, deepest roots, to enrich our sense of belonging to (and identity with) this special place, and celebrate it with community events;
- **build** stronger connections with the ecology of surrounding areas (West Wiltshire and Dorset AONBs, Landscape Character Areas, SSSIs, the royal forest, not forgetting "dark skies" and the star-scape), and their natural cycles - daily, seasonal, and annual - highlighting patterns of habitats for plants and animals that provide shelter or resources for humans across millennia;
- **create** an overarching scheme for updated historic and cultural interpretation, signage and management of open spaces, with upgraded street-scaping, using a holistic approach (rather than past piecemeal efforts) to link up all the town's assets, thus encouraging greater public engagement locally;
- **foster** the arts by inviting both groups and individual practitioners in and around the town to take inspiration from our project, reflecting its themes in their work;
- and overall to **promote** the town's unique character, as outlined here, more innovatively and widely, in our area and beyond.

We aim to hold to account local and regional decision-makers, by showing them how to understand, value and love this place as we do. We aim to offer a demonstration project to other similar towns, showing how each can make the most of their own particular assets. We believe that our initiative can raise cultural, physical and mental, and economic health and wellbeing in our town and across the region.

Project Enquiry Form

Summary

What is the title of your project?

In no more than 15 words, please choose a title which you think best describes your project.

Building our future by celebrating our people's heritage & culture - Shaftesbury Monuments Initiative

Reference number

OH-17-06590

Date received

03/01/2018

Section One - Your Organisation

1a Name and address of your organisation

Name of your organisation Shaftesbury Town Council

Address line 1

Town / city SHAFTESBURY

County Dorset

Postcode SP7 8HW

1b Details of main contact person

Name Matthew Tagney

Position Member of Shaftesbury Open Spaces Group

Is the address of the main contact person the same as the address in 1a?

Yes

Daytime phone number, including area code

REDACTED

Alternative phone number REDACTED

Email address REDACTED

1c Are you a not for profit organisation?

Yes

Please tell us the type of your organisation.

Parish Council advised by voluntary organisation

1d Where did you hear about the Heritage Lottery Fund? Please pick from list or specify below.

HLF website

Section Two - The Heritage

2a What is the heritage that your project will focus on?

A group of six Scheduled Monuments which are either in the care of Shaftesbury Town Council (STC) or for

which STC has certain responsibilities.

Section Three - Your Project

3a Is the address of your project the same as the address of your organisation?

Yes

3b Describe what your project will do.

what our project will do.

Section Four - Project Management

4a When do you expect your project to start and finish?

When we expect to start and finish.

Section Five - Project Costs

5a How much is your project likely to cost? If you know, tell us what the major costs are likely to be.

likely cost and major cost items.

5b How much are you likely to ask for from us?

£50,000

Please use the button below if you would like to attach any documents, such as images, to your form.

Once we receive this form we aim to contact you within 10 working days.

Appendix C. Project Detail

Draft for approval or amendment by ROSE committee meeting 20/3/18

OSG requests that ROSE decides:

- either to approve, or propose amendments to, the drafts below and attached;
- whether OSG (stating that it acts on behalf of STC), or STC itself, will submit the Project Enquiry Form online.

Draft text below is for insertion in HLF's online Project Enquiry Form at sections:

- 3b what your project will do;
- 5a likely cost and major cost items.

HLF sets an overall word limit for the Form of 1,000 words, so we have used 700 words for 3b, and 200 words for 5a, aiming to complete the form in about 950 words.

Attached for ease of reference are:

- dummy copy of form (we plan a total cost of £60k/ ask HLF for £45k);
- story document "*Celebrating the long view*", and a sketch map, both to be attached to the form when submitted online.

3b what our project will do

This project uses a group of nationally-recognised monuments, of unrivalled scale in Dorset, to launch initiatives enabling Shaftesbury to achieve a cumulative impact comparable with historic cities such as Winchester, Exeter or Salisbury. Our vision:

- encourage Shastonians to do justice to their long and rich heritage with celebration, conservation, innovation and the arts.

The project improves conservation and appreciation of, access to, and community engagement with our scheduled monuments, by:

- **exploring** our town's ancient origins: from oldest residents to newest arrivals, everyone can share the excitement of discovering our deepest roots, to enrich our sense of belonging to (and identity with) this special place, and celebrate it;
- **building** connections with the surrounding landscape and ecology (West Wiltshire/ Dorset AONBs, Landscape Character Areas, SSSIs, the Royal Forest, "dark skies" and the star-scape), and their natural cycles - daily to annual - highlighting patterns of animal and plant habitats providing resources and shelter for humans across millennia;
- **creating** an overarching historic and cultural interpretation and management of open spaces, using a holistic approach (rather than past piecemeal efforts) to link up all the town's assets, encouraging public engagement;
- **fostering** art and design by inviting groups and individual practitioners around the town to take inspiration from our project, reflecting its themes in their work with commissions and events;
- **promoting** the town's unique story, told in "*Celebrating the long view*" (below), more innovatively and widely in our area and beyond, focused on **Gold Hill** as our emblem: famous world-wide, it is the hub from which our key themes emerge;
- offering a **demonstration project** to other towns, showing how each can make the most of their particular assets. This project can raise cultural, physical, mental, and economic health and wellbeing in Shaftesbury and across our region.

Our outcomes include:

Gold Hill: annual parade - Bicycles Through the Ages, based on baker's-boy bone-shaker from famous "Hovis" TV commercial;

Park Walk / Abbey ruins: a sculpture loaned annually by a local artist living or recent, to display and use as a focal point for talks/ events;

Castle Green: centenary celebration of saving of the Green as an open space for all townspeople in 1919, after it was initially sold off to speculators. Early preparations already underway for this event;

Boltbury (Castle Mound): create a holographic 3D virtual model of how the Norman fortification looked in the time of the Anarchy (C.12 civil war between King Stephen and Empress Matilda), when this area was the front line between opposing forces (Battle of Wilton, surrender of Sherborne etc), and create a new access path helping to reveal the site's structure while minimising erosion and scrub damage;

Bury Litton (St John's churchyard): find exact spot where the church stood, and mark it for future generations e.g. by tracing its outline in snowdrops etc.

All monuments:

-a conservation management plan for each scheduled monument for which STC has responsibilities, agreed jointly by STC, Historic England and relevant owners;

-link up the group of monuments physically, by unified signage, street furniture and surfacing, to lead visitors from one site to the next and make sense of the whole, and by high-quality, accessible leaflets - one for each monument, linking them together.

We will work with locally- and regionally- based fine art practitioners, with newly commissioned works being used to raise funds for e.g. upkeep of Gold Hill Wall;

Our volunteers will come from the Shaftesbury area’s lively and energetic volunteer culture. We will draw individuals from a wide range of local groups whose interests overlap with the aims of this Initiative, from history, archaeology, open spaces and wildlife groups to creative groups based on the Arts Centre, local businesses via the Chamber of Commerce, and young people through local schools, youth groups etc.

In order to source our match funding, we will work with Abbey Museum Gardens (AMG) Trustees who successfully assembled funding for their SAVED project: we will learn from them, tapping sources that complement AMG’s efforts, and seek local authority approval to use s.106 funding earmarked for the Castle site.

“*Celebrating the long view*” (attached) states our vision for the future of Shaftesbury’s unique group of ancient monuments, and lists them individually. [690 words]

5a likely cost and major cost items

Estimates are full costs. The project will seek partial funding from other sources (local authorities, charitable trusts, businesses); professional advice and practical work costs partly met by contributions in kind from relevant experts / volunteer effort.

<i>Work</i>	<i>Timing</i>	<i>Cost £k</i>
[A] Overall project management		
Fees for contracts for services with:	Autumn 2018 to spring 2020	9.0
[i] expert facilitator (1 day per month for 18 months) £500 pd;		
[ii] consultant quantity/ chartered surveyor: 10 days at start, £300 pd;	2018	3.0
[iii] design/ print guides, interpretation displays: £700 per site.	2019	4.0
[B] Capital works		
[iv] produce/ install durable interpretation boards x6	2019	4.0
[v] finger-posts (heritage design) for pedestrians, linking 6 sites: 10 at junctions.	2019	10.0
[vi] Re-surface thresholds/ junctions: replace plain tarmac by heritage-quality resin-bound permeable surface (robust enough for vehicles with access rights)/ stone-banded edges/ drainage channels, to:	2020	30.0
[a] lead pedestrians on circular route;		
[b] emphasise unity of 6 sites;		
[c] mark thresholds/ junctions e.g. High St to Abbey.		
Total 500 m2. (Phase 1 of longer-term plan: if this succeeds, 2 nd phase will include contrasting textures outlining Abbey remains underground, surveyed by sister project SAVED: approx. 4,000 m2.)		
Total (including match funding/ contributions in kind)		£60k

[ends]

Appendix D. Monument Locations

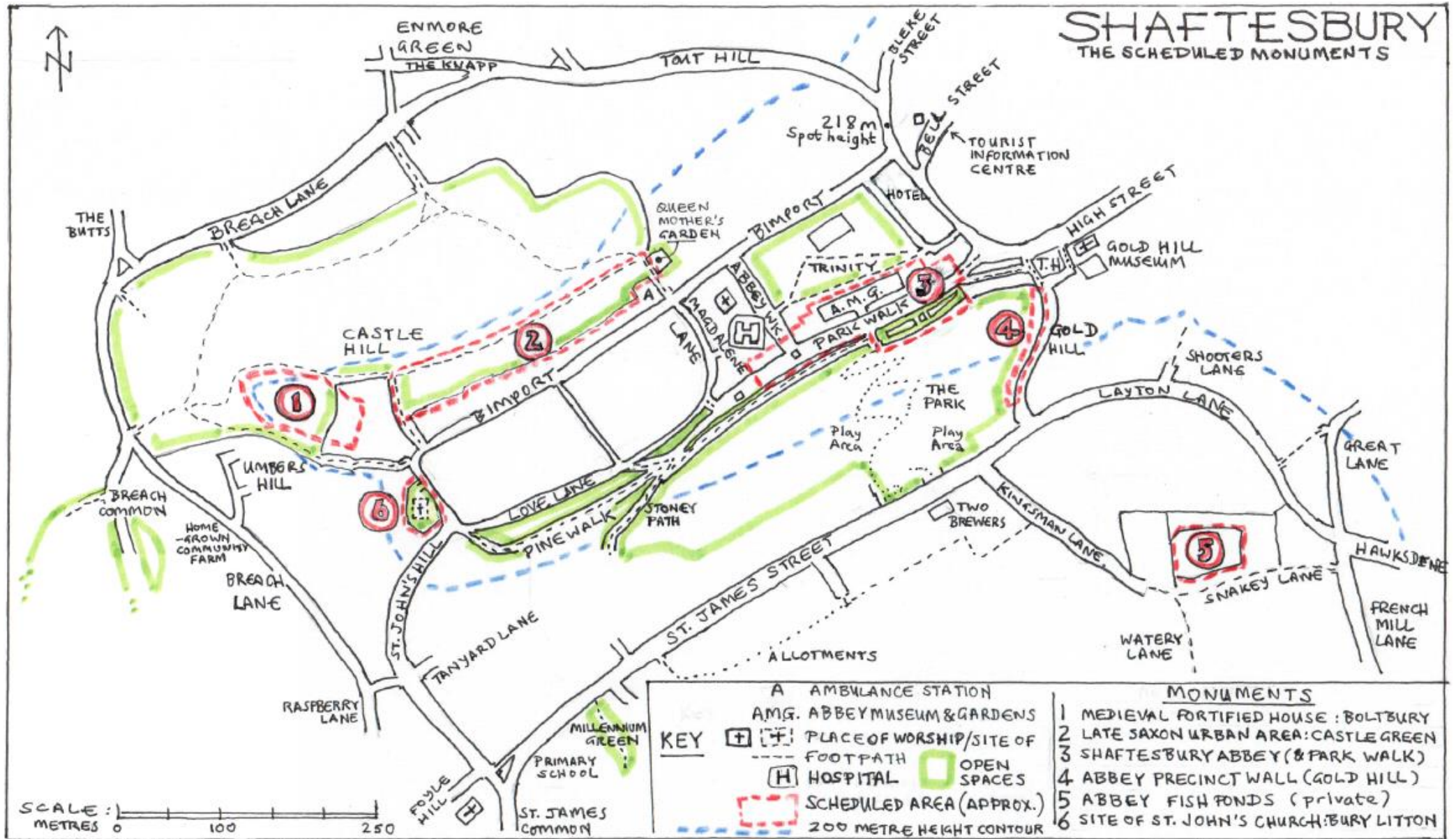

**Report 0318ROSE5 to a meeting of the Recreation, Open Spaces and Environment
Committee**
**To be held at 7.00pm on Tuesday 20 March 2018 in the Council Chamber,
Shaftesbury Town Hall**

5 Gold Hill Wall

To consider management plan for vegetation on and on top of the wall

5.1 Recommendation

- 5.1.1 That the Head Groundsman, representative from Shaftesbury Open Spaces Group and the Lead Councillor for Residents Lifestyle Outdoors work together on a management plan for approval by Historic England for incorporation into the routine schedule of grounds work.
- 5.1.2 That the Council buys appropriate harnesses and associated equipment and provides training to all members of the grounds team for working on the top of Gold Hill Wall.
- 5.1.3 Recommend to the HR and General Management Committees the review of policies relating to Risk Assessment, Health and Safety and Working at Height.

5.2 Background

- 5.2.1 There are two areas of concern regarding vegetation associated with Gold Hill Wall. The first being the vegetation growing out of the wall (predominantly but not exclusively valerian) and the vegetation growing on the ground at the top of the wall.
- 5.2.2 Shaftesbury Town Council does not own Gold Hill Wall but has an interest in its upkeep as an internationally iconic location. It also has an interest in looking after the Scheduled Ancient Monuments (see agenda item 4 above).
- 5.2.3 The grounds team last worked on the vegetation at the top of the wall approximately 3 years ago. Without correct safety equipment the team is not able to continue carrying out this work.
- 5.2.4 Because the wall is a Scheduled Ancient Monument, any work on the wall or directly relating to the wall must be agreed by Historic England. As such, it is recommended that the Town Council works with Shaftesbury Open Spaces Group and Historic England to put a maintenance plan in place.

5.3 Legal Implications

- 5.3.1 Gold Hill Wall is not owned by Shaftesbury Town Council, but St James' Park is. The Council has a duty to maintain St James' Park and an interest in the maintenance of Gold Hill Wall.
- 5.3.2 The Council has a duty of care to its staff and must ensure proper risk assessment, training and equipment is provided before carrying out work at height.

5.4 Financial Implications

- 5.4.1 There are no financial implications arising from drawing up a schedule of work.

5.4.2 There will be cost implications for training and equipment, this will be considered by the HR and ROSE Committees respectively in due course and before implementation of the work schedule.

5.5 Risk

5.5.1 There is a risk of injury to staff from working at height. Associated Health and Safety and Risk Assessment policies must be reviewed and updated if necessary before a new schedule of work is implemented.

(End)

Report Author:
Claire Commons, Town Clerk

**Report 0318ROSE6 to a meeting of the Recreation, Open Spaces and Environment
Committee
To be held at 7.00pm on Tuesday 20 March 2018 in the Council Chamber,
Shaftesbury Town Hall**

6 Salisbury Street Green

To consider requesting taking ownership of Salisbury Street Green

6.1 Recommendation

6.1.1 That Shaftesbury Town Council requests of Dorset County Council to take ownership of Salisbury Street Green.

6.2 Background

6.2.1 The area of grass at Salisbury Street leading to Martin's Street is owned by Dorset County Council (see Appendix E below). A small portion on the eastern side of this land has been sold to a private resident, the remainder of the land is currently looked after by Shaftesbury Town Council and volunteers.

6.2.2 The Town Council has previously indicated to Dorset County Council an interest in taking ownership of this land to protect it as a green open space. The Council is looking to take a co-ordinated approach in looking at all areas of open space.

6.3 Financial Implications

6.3.1 There are no identified costs for taking ownership of the land. There are ongoing costs for continued maintenance of the area which are incorporated into the Grounds Team budget.

6.4 Legal Implications

6.4.1 The Town Council may acquire and manage outdoor spaces.

6.4.2 The area has an artificial badger sett which is protected by law.

6.5 Risk

6.5.1 There is a legal risk if the council breaches the protection provided to the badgers by law.

(End)

Report Author:
Claire Commons, Town Clerk

Appendix E. Salisbury Street Green



**Report 0318ROSE7 to a meeting of the Recreation, Open Spaces and Environment
Committee
To be held at 7.00pm on Tuesday 20 March 2018 in the Council Chamber,
Shaftesbury Town Hall**

7 Footpaths

To review the condition and access of footpaths in Shaftesbury and identify any actions arising

7.1 Recommendation

7.1.1 That the Committee carries out an 'on the ground' review of all definitive footpaths in Shaftesbury.

7.2 Background

7.2.1 Shaftesbury has a large network of footpaths; these are shown on the map at Appendix F below.

7.2.2 Shaftesbury Open Spaces Group and Shaftesbury Town Council have both been made aware of problems on certain footpaths and the Shaftesbury Open Spaces Group have requested that the Town Council look into the condition of footpaths with a view to making recommendations for improvements or remedial action where necessary.

7.3 Legal Implications

7.3.1 Footpaths are the responsibility of Dorset County Council. Shaftesbury Town Council has the power to make recommendations for improvement and to represent its community on matters of concern.

7.4 Financial implications

7.4.1 There are no financial implications arising from this report

7.5 Risk

7.5.1 There are no risks arising from this report.

(End)

Report Author:
Claire Commons, Town Clerk

Appendix F. Shaftesbury's Footpaths

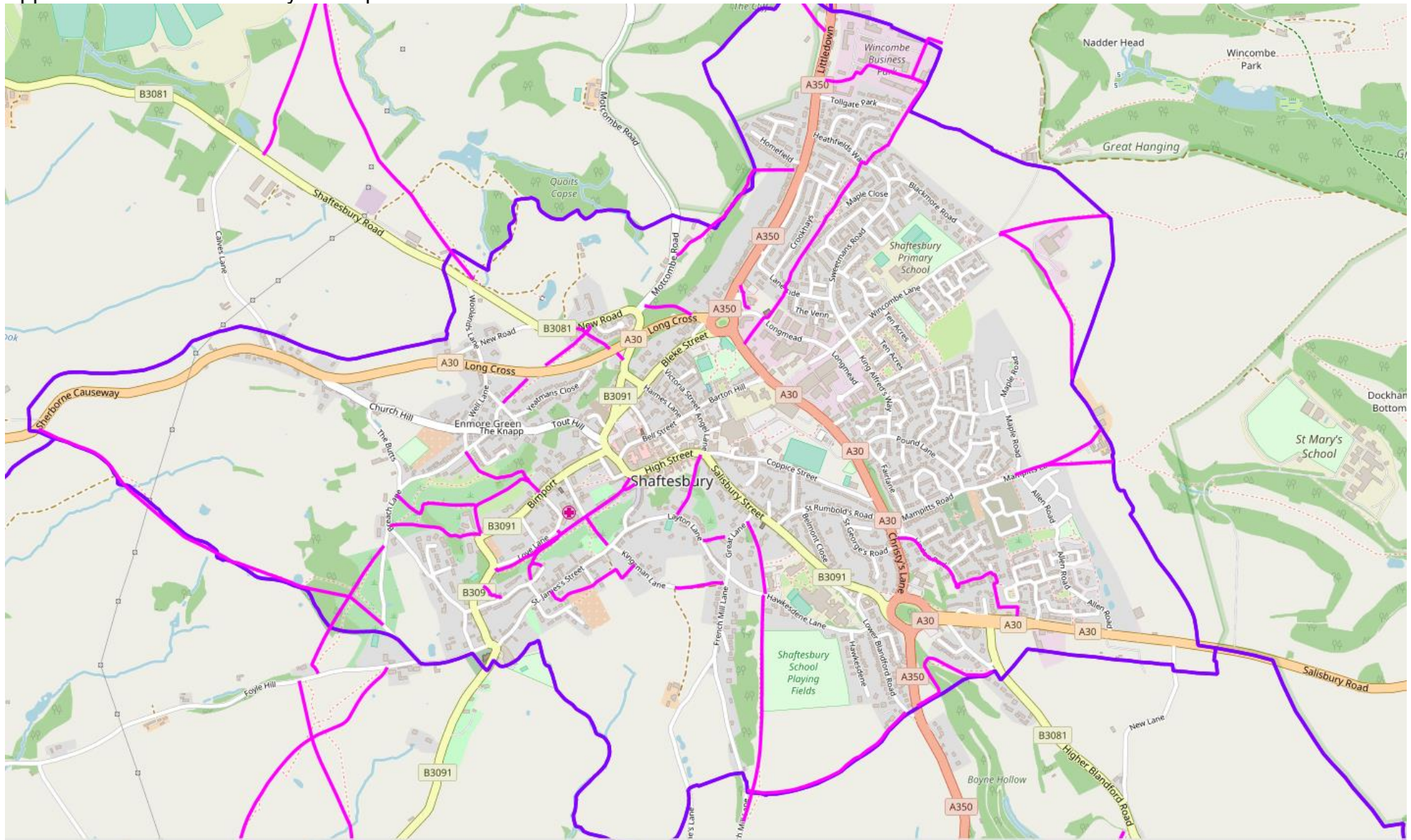

© Crown copyright and database rights 2018 OS LA100019790. Use of this data is subject to terms and conditions. © Dorset County Council 2018. Contains Ordnance Survey Data. Crown Copyright and Database Right 2018. The Rights of Way depicted on this plan show the approximate routes only. For any legal purpose please refer to the Definitive Map. This is kept at County Hall and can be viewed by appointment during office hours. © OpenStreetMap contributors CC-BY-SA

**Report 0318ROSE8 to a meeting of the Recreation, Open Spaces and Environment
Committee
To be held at 7.00pm on Tuesday 20 March 2018 in the Council Chamber,
Shaftesbury Town Hall**

8 Castle Mound

To consider management and improvement to Castle Mound

8.1 Recommendation

- 8.1.1 That the cost for increasing the frequency of mowing on Castle Hill by the Rangers is determined and brought back to the committee for approval.
- 8.1.2 That the management plan detailed below is approved and submitted to Historic England and North Dorset District Council for approval prior to implementation.

8.2 Background

- 8.2.1 Shaftesbury Open Spaces Group have met and recommend that the frequency of mowing on the mound is increased from 2 times per year to 6 times.
 - 8.2.1.1 Shaftesbury Tree Group and Shaftesbury Open Spaces Group recommend the following management and improvement plan for submission to Historic England and then draw down of s.106 funds for implementation.
- 8.2.2 The site was historically grazed by cattle until the mid 1980's, since then various self seeded material has formed a low dense understorey covering the ancient monuments slopes and blocking important open views across the vale.
- 8.2.3 Long term management is to retain larger trees but manage younger saplings by introducing them to a more regular coppicing cycle. Many have already been coppiced and therefore this management seems most appropriate to prevent damage to the ancient mound.

8.3 Proposal prepared by Shaftesbury Open Spaces Group and Shaftesbury Tree Group

- 8.3.1 G1 -Re-coppice young self seeded growth on northern top slopes (hazel, elder, hawthorn, sycamore etc.) over a 5 to 7 year period to maintain and manage views across the Blackmore vale landscape. Retain mature Thorn and Holly.

G2- As above on Western boundary of top slope

G3- As above on Southern boundary of top slope

Remove dense shrub growth of box honeysuckle (*Lonicera nitida*) along eastern boundary to permit creation of path to the mound, proposed in order to reduce traffic directly up the mound which is resulting in soil erosion- A Section 211 notification is not required for this.

G4- Re-coppice young self seeded growth on upper slope of northern boundary on the northern side of the Rangers footpath to permit views across the vale and proactively manage coppice derived growth.

Mark the location of the groups on a site plan and state how long we require the consent to cover i.e. 5 or 7 years.

8.4 Financial Implications

8.4.1 Financial Implications for the identified work will be sought if the Committee is in agreement to proceed. These costs will be brought back for determination.

8.5 Legal Implications

8.5.1 The Town Council has a duty to protect the Scheduled Ancient Monument and to take care of its open spaces.

8.6 Risk

8.6.1 There is risk of incorrect management of the Scheduled Ancient Monument. This is mitigated by submission of the plan to Historic England for approval prior to undertaking the work.

(End)

Report Author:
Claire Commons, Town Clerk

**Report 0318ROSE10 to a meeting of the Recreation, Open Spaces and Environment
Committee
To be held at 7.00pm on Tuesday 20 March 2018 in the Council Chamber,
Shaftesbury Town Hall**

9 Wincombe Recreation Ground

To agree expenditure for replenishing safety bark at Wincombe Recreation Ground

9.1 Recommendation

9.1.1 That replacement border and safety bark is purchased for Wincombe Recreation Play Area.

9.2 Background

9.2.1 The safety surface for Wincombe Recreation Ground is in need of replacement and is required to provide a safe play environment.

9.3 Financial Implications

9.3.1 Play area edging £230

9.3.2 Safety bark £3230.50

9.4 Legal Implications

9.4.1 The Council has a duty to ensure its play areas are safe.

9.5 Risk

9.5.1 There is a risk of injury if the correct safety surfaces are not kept in good order

(End)

Report Author:
Claire Commons, Town Clerk

Report 0318ROSE10 to a meeting of the Recreation, Open Spaces and Environment Committee

To be held at 7.00pm on Tuesday 20 March 2018 in the Council Chamber, Shaftesbury Town Hall

10 Officer Report

To receive and note officer report and any correspondence relating to the work of the Committee

10.1 Recommendation

10.1.1 That the report is received and noted.

10.2 Project updates

10.2.1 Jubilee Path – The footpath on the line of the definitive footpath was installed on 19th February, the final decorative and anti-slip bonded resin surface is scheduled to be carried out in the week commencing 19th March 2018 once the oxidation process has occurred. A project review needs to be undertaken, it is recommended that this is carried out by the lead councillor and officer and any other interested parties.

10.2.2 Cycle Speedway – a draft agreement to lease is hand with the Council's solicitor which encompasses the criteria required to be met ahead of a signed lease. The Rotary have carried out additional consultation, hand-delivering 100 letters to residents adjacent to the site location at Wincombe Recreation Ground. This has attracted seven letters of objection or concern, five of which were submitted directly to the Rotary and have been personally responded to by them. This is in advance of the planning process which will have its own consultation process.

10.2.3 A30 Allotments – this is currently waiting for the transfer document from North Dorset District Council, there has been a slight delay while permission to waive a 6 month amendment clause with DCC was negotiated, this has now been waived and the final transfer is awaited. A formal specification is required for inviting tenders, a quote has been received in the region of £7,500 and an alternative for that work is now sought so that it doesn't impact too heavily on the budget for the groundworks.

10.2.4 Jubilee Railings – a meeting is still being sought between Cllr Hall and a nominated representative of the Shaftesbury Open Spaces Group to agree the specification for railings which will then be used for quotes for this specific project but will also inform the design of future works throughout the town.

10.2.5 Park Walk Shelter – Work has been carried out to regenerate the shelter, repairs made and painting completed. The previous lights were beyond repair and have been boxed in.

10.2.6 Castle Hill Trees – Oaks have been planted in memory of Mrs Rachel Caldwell on the green at the bottom of Castle Hill. 6 Countryside Rangers, 10 volunteers from Shaftesbury Open Spaces group and the Shaftesbury Tree group then planted 165 trees of mixed varieties at Castle Hill to enhance the area for people and wildlife.

10.2.7 Lychgate – the cemetery lychgate and structure is having minor repairs, the gate is currently in storage waiting for welding.

10.2.8 Allotments – The annual collection of allotment rents is nearly complete and the waiting lists at each site are currently:

A30 5 waiting

Mampitts 7 waiting, 1 plot to be reassigned, waiting list of approximately 5 years.

St James 1 waiting, 4 plots to be reassigned, waiting list of approximately 1 year

Bray 0 waiting, 1 plot to be reassigned

Waiting list for those expressing no preference for a particular site is currently 11 people long and a waiting list of 1 year.

10.3 **Correspondence**

10.3.1 Correspondence has been received objecting to the newly installed footpath at St James Park. The project review identified above should take into consideration the correspondence received.

(End)

Report Author:
Claire Commons, Town Clerk